

ADBW240VGP - WELD HM AD 9-13 VAR. SHADE PAT

SHADE GUIDE TABLE (NO.1)

Welding Process	ARC CURRENT (Amperes)															
	0.5	2.5	10	20	40	60	80	100	125	175	225	275	350	450		
SMAW					9	10			11		12		13	14		
MIG(heavy)								10	11		12		13	14		
MIG(light)								10	11	12		13	14	15		
TIG,GTAW				9	10			11	12		13		14			
MAG/CO2								10	11	12		13	14	15		
SAW									10	11	12	13	14	15		
PAC									11		12		13			
PAW		8	9	10	11	12			13			14	15			

NOTE:

SMAW – Shielded Metal Arc Welding
 MIG (Heavy) – MIG on Heavy Metals
 PAW – Plasma Arc Welding
 SAW – Shielded Semi-Automatic Arc Welding

TIG, GTAW – Gas Tungsten Arc Welding
 MIG (Light) – MIG on Light Alloys
 PAC – Plasma Arc Cutting
 MAG/CO2 – Metal Active Gas

PARTS LIST & ASSEMBLY

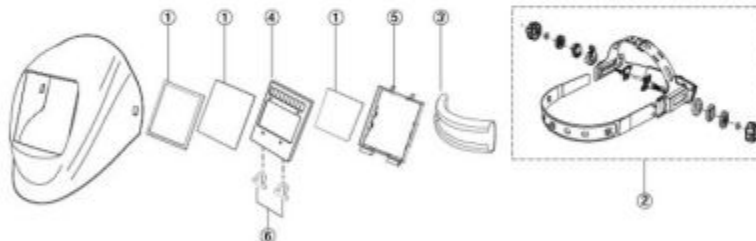

Reference Number	Description	Part No.
1	Front cover lens kit — 4 Front/2 inner lens covers and rubber seal	MAV244LK
2	Head Gear	MHG18
3	Sweatband	MJB18
4	Replacement AD Lens	ADRL240
5	Retaining frame	RF18
6	Batteries(2pcs)	CR2450

Item: ADBW240VGP

Description: WELD HM AD 9-13 VAR. SHADE PAT

Notes: N/A

Figure No	Part Number	Description	No. Reqd	Warranty Code
1	MAV244LK	LENS KIT FOR (ADBW244VG-D) 4 F	1	T
2	MJB18	WELDING HELMET HEAD BAND	1	T
3	MHG18	HEAD GEAR	1	B
4	*JYADRL240	REPLACEMENT AD LENS	1	
5	JYRF18	RETAINING FRAME F/PBW10,ADBW18	1	X
6	*JYMMCR2450	BATTERIES (2PC)	2	