

BR10STA - 3/8" 100 TOOTH SWIVEL ROUND RA



AR6STRKA, BR10STRKA, CR11STRKA
1/4" Dr., 3/8" Dr., 1/2" Dr. Swivel Head Ratchet Repair Kits



Parts Breakdown

No.	Description	Qty
1	Yoke	1
2	* 1/4", 3/8", 1/2" Dr. Head	1
3	* Handle Screw	1
4	* Spring Washer	2

= Not included in Repair Kit
 * Included in Repair Kit

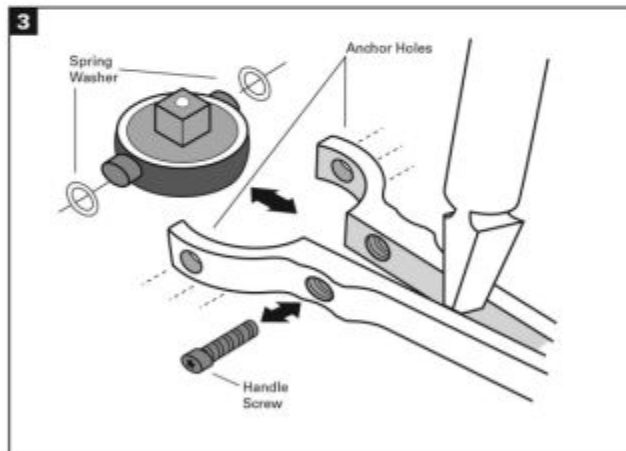
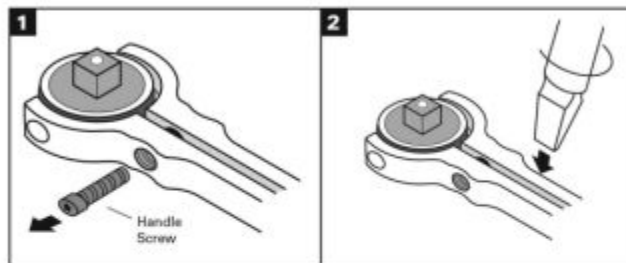

Disassembly/Assembly Instructions

- 1** Remove Handle Screw.
- 2** Insert a flat head screwdriver into the yoke handle slot.
- 3** Spread the handle yoke to remove the existing head and spring washers.
4. Place the spring washers on each of the pivot posts of the new head.
5. Position the new head and washers between the anchor holes on each side of the handle yoke.
6. Slowly release the tension on the yoke handle.
7. Tighten the handle screw.
8. Check the head for binding by rotating the new head back and forth through 180°.

Read all instructions carefully before attempting the assembly or disassembly of this tool. Keep fingers clear of pinch point.

Item: BR10STA

Description: 3/8" 100 TOOTH SWIVEL ROUND RA

Notes: N/A

Figure No	Part Number	Description	No. Reqd	Warranty Code
-----------	-------------	-------------	----------	---------------