

BWC155 - 6/12/24V 60/70A WHL CHARGER

If using OBDII cord insure that no external loads are on (like interior lights); above 5A fuse will open. If using the male to male cord, limit continuous current draw to 15A. Caution: the positive terminal will be live; be extremely careful not to allow it to short to ground.

WIRING DIAGRAM

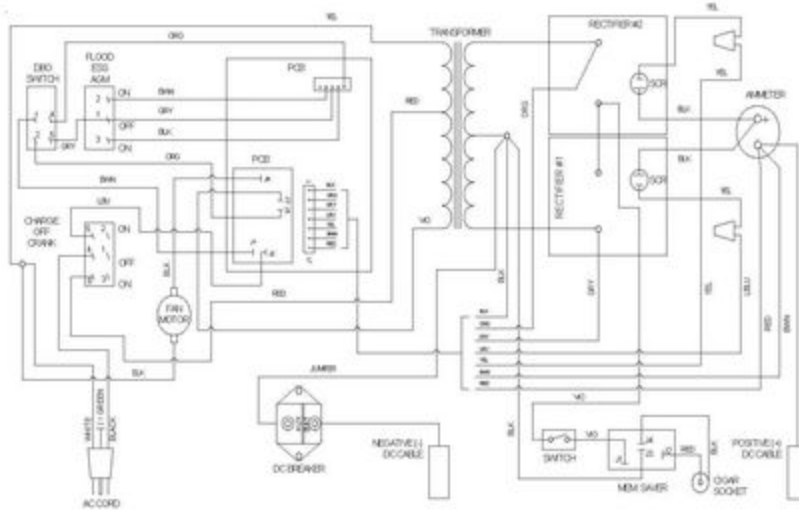

BWC300 REPAIR PARTS

Item	Description	Part No.
1	Aide whilts	610052
2	Wheel whilts (2)	611157
3	Rectifier (#1)	611471
4	Rectifier (#2)	611472
5	Transformer	611469
6	Harness	611237
7	Fan Blade	610189
8	Fan Motor w/blade	610190
9	DC Circuit Breaker	610536
10	Switch Dead Battery Override	610263
11	Switch ON-OFF-ON	611167
12	AC Cord	611185
13	DC Cable Set	611219
14	Clamps (1 pair w/jaws)	6199
15	Jaw Kit (repairs 1 clamp)	610970
16	Control PCB	611311
17	Control Fan, PCB	611470
18	Ammeter	605204
19	Memory Saver PCB	611256
20	Cigar Socket	611257
21	Switch	611258
22	Switch DPDT	611300
Parts Not Shown		
	Handle	605213
	Clamp Bar	610517

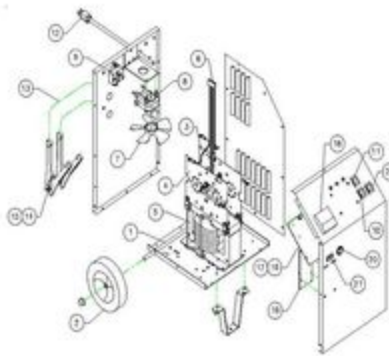

MAINTENANCE INSTRUCTIONS

Worn clamps should be replaced. Worn parts can lead to poor connections and present a safety hazard. See parts list for part number of D.C. Cord kit. Any Maintenance or repair of this unit that involves disassembly of the cabinet should be done only by a qualified serviceman. Incorrect reassembly may result in a risk of electric shock when the unit is subsequently used. For local service in your area go to www.associatedequip.com and click on Repairs Centers.

Item: BWC155

Description: 6/12/24V 60/70A WHL CHARGER

Notes: The BWC155 is covered by a Bumper to Bumper 2-Year Warranty Plus an addition 3-Year limited additional warranty for a total of 5-years covering the Transformer and Rectifier the two most expensive components in a charger

Figure No	Part Number	Description	No. Reqd	Warranty Code
1	GM610825	LEG	1	X
2	GM605672	WHEEL KIT F/BC160IO	1	X
3	GM610052	AXLE	1	X
4	GM610862	TRANSFORMER F/ MC600	1	X
5	*GM611484	RECTIFIER	1	
6	*GM611201	FAN BLADE	1	
7	*GM611485	FAN MOTOR	1	
8	GM611245	TIMER, 120 MINUTE, 120 VAC	1	X
9	GM605204	AMPS CHARGE METER	1	X
10	GM610536	CIRCUIT BREAKER	1	X
11	GM610820	DC CABLE SET	1	X
12	*GM611248	AC CORD	1	
13	GM611083	SWITCH W/ KNOB	1	X
14	GM6202	PR 500 AMP CLAMPS	1	X
15	GM610970	CLAMP REPAIR KIT	1	X
16	GM603147	BC160 CONTROL KNOB	1	X
17	GM603597	CIRCUIT BREAKER	1	X
18	GM605213	HANDLE FOR BWC150	1	X
19	GM610517	CROSS BAR FOR HANDLE	1	X
20	*GM611476	PCB, AGM	1	