

BWC300 - SMART CHARGER

If using OBDII cord insure that no external loads are on (like interior lights); above 5A fuse will open. If using the male to male cord, limit continuous current draw to 15A. Caution: the positive terminal will be live; be extremely careful not to allow it to short to ground.

WIRING DIAGRAM

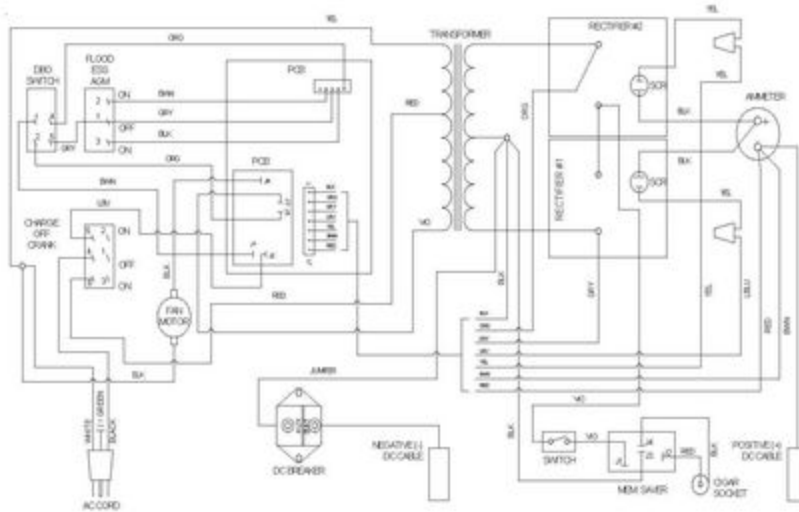

BWC300 REPAIR PARTS

Item	Description	Part No.
1	Ade whilts	610052
2	Wheel whilts (2)	611157
3	Rectifier (#1)	611471
4	Rectifier (#2)	611472
5	Transformer	611469
6	Harness	611237
7	Fan Blade	610189
8	Fan Motor w/blade	610190
9	DC Circuit Breaker	610536
10	Switch Dead Battery Override	610263
11	Switch ON-OFF-ON	611167
12	AC Cord	611185
13	DC Cable Set	611219
14	Clamps (1 pair w/jaws)	6199
15	Jaw Kit (repairs 1 clamp)	610970
16	Control PCB	611311
17	Control Fan, PCB	611470
18	Ammeter	605204
19	Memory Saver PCB	611256
20	Cigar Socket	611257
21	Switch	611258
22	Switch DPDT	611300
Parts Not Shown		
	Handle	605213
	Clamp Bar	610517

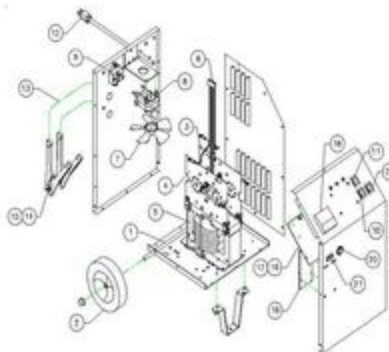

MAINTENANCE INSTRUCTIONS

Worn clamps should be replaced. Worn parts can lead to poor connections and present a safety hazard. See parts list for part number of D.C. Cord kit. Any Maintenance or repair of this unit that involves disassembly of the cabinet should be done only by a qualified serviceman. Incorrect reassembly may result in a risk of electric shock when the unit is subsequently used. For local service in your area go to www.associatedequip.com and click on Repairs Centers.

Item: BWC300

Description: SMART CHARGER

Notes: Intellamatic Smart Charger BWC300 is covered by a 2-year Bumper to Bumper Warranty, plus 1 year addition Limited additional warranty for a total of 3-years covering the Transformer and Rectifier the two most expensive components in a charger

Figure No	Part Number	Description	No. Reqd	Warranty Code
1	GM610052	AXLE	1	X
2	*GM611157	WHEEL W/NUTS	2	
3	*GM611471	RECTIFIER(#1)	1	
4	*GM611472	RECTIFIER(#2)	1	
5	*GM611469	TRANSFORMER	1	
6	*GM611237	HARNESS	1	
7	GM610189	BLADE	1	X
8	GM610190	FAN MOTOR	1	X
9	GM610536	CIRCUIT BREAKER	1	X
10	610263	SWITCH F/ET6029	1	T
11	GM611167	SWITCH, SPDT, BATTERY SELECT	1	L
12	*GM611185	AC CORD	1	
13	*GM611219	DC CABLE SET	1	
14	GM6199	400 AMP CLAMP KIT	1	X
15	GM610970	CLAMP REPAIR KIT	1	X
16	*GM611311	CONTROL PCB	1	
17	*GM611470	CONTROL FAN, PCB	1	
18	GM605204	AMPS CHARGE METER	1	X
19	*GM611256	MEMORY SAVER PCB	1	
20	*GM611257	CIGAR SOCKET	1	
21	*GM611258	SWITCH	1	
22	GM611300	ROCKER SWITCH, DPDT	1	X
23	GM605213	HANDLE FOR BWC150	1	X
24	GM610517	CROSS BAR FOR HANDLE	1	X