

# Lever Grease Guns Heavy Duty

<b>G1-HD</b>	<b>G4-HD</b>
<b>G10-HD</b>	<b>G18-HD</b>

Top of the line grease gun for heavy industrial applications.

### Built Tough

- Barrel with 0.049" (1.2 mm) wall thickness.
- Heavy duty follower spring.
- High tolerance CNC machined, aluminium die cast head.
- Rolled threads for quick & easy re-loading.

### Variable Stroke

Convenient greasing even in tight spaces with limited movement of handle.

### Available in 2 choices

- 6" (150 mm) steel extension & coupler.
- 12" (300 mm) x 0.33" (8.5 mm) flexible hose & coupler.

**DEVELOPS**

**UPTO  
10,000 PSI  
(690 BAR)**

**DELIVERS**

**UPTO  
1 GM / STROKE  
(1 OZ. / 28 STROKES)**

**VARIABLE  
STROKE**



Aluminium die cast head with bulk loader and air bleeder valve

Zinc plated lever handle

Ergonomic rubber grip

Lock Lever: Locks plunger rod at any position

## SPECIFICATIONS

<b>HANDLE STYLE</b>	Lever
<b>COUPLER</b>	Professional 4-jaw with ball check
<b>THREAD</b>	1/8" BSPT / M10x1 / 1/8" NPT

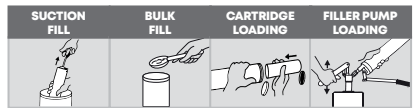

CAT NR.	CAT NR.	CARTRIDGE CAPACITY		BULK CAPACITY (CM <sup>3</sup> )	THREADS
		(OZ)	(GMS)		
6" (150MM) STEEL EXTENSION & COUPLER	12" (300MM) FLEXIBLE HOSE & COUPLER				
G1R/HD/B	G1F/HD/B	14	400	500	1/8" BSPT
G1R/HD/M	G1F/HD/M	14	400	500	M10 x 1
G1R/HD/N	G1F/HD/N	14	400	500	1/8" NPT
G4R/HD/B	G4F/HD/B	-	450	650	1/8" BSPT
G10R/HD/B	G10F/HD/B	14	400	750	1/8" BSPT
G10R/HD/M	G10F/HD/M	14	400	750	M10 x 1
G10R/HD/N	G10F/HD/N	14	400	750	1/8" NPT
G18R/HD/M	G18F/HD/M	21	600	700	M10 x 1

## SAFETY INFORMATION

- Follow workshop Health & Safety rules, regulations and conditions when using the grease gun.
- During their period of use, accessories must be checked for wear, cracks and other damage, replace any damaged or worn parts.
- Use genuine parts only. Unauthorized parts may be dangerous and will void the warranty.
- Wear approved safety gloves and eye and ear protection.
- Keep the gun clean and in good working order for best and safest performance.

### WARNING!

- DO NOT use the gun for a task it is not designed to perform.
- DO NOT drop, throw or abuse the gun.
- DO NOT carry the gun by the extension.
- Grease is delivered at high pressure. DO NOT point the grease gun outlet at yourself or others.
- DO NOT use gun if damaged or thought to be faulty. Contact your local service agent.

## PACKAGE CONTENT

DESCRIPTION	QUANTITY
Lever grease gun Heavy duty	1
Extension (Rigid steel / Flexible hose) with grease coupler	1
O.I.P.M.	1

## TOOLS NEEDED

- 14 mm spanner / 9/16" spanner

## BEFORE INSTALLATION

- Use only original accessories compliant with these guns.
- Keep hose away from heat, oil and sharp edges. Check hose for wear and make sure that all connections are secure.
- Excess pressure at the greasing point can damage the grease nipple, bearings, and even the machine.

### WARNING!

- Defective accessories can lead to personal injury and material damage.

## INSTALLATION

(Refer "EXPLODED VIEW")

### Setting up the grease gun head

**Note:** Use P.T.F.E. tape while connecting extension (4) to the grease gun head (2) and grease coupler (3) to the extension (4).

1. Connect the extension (4) to the outlet of grease gun head (2).

2. Thread tighten the grease coupler (3) to other end of extension (4).
3. All connections should be tight.

### CAUTION!

Grease or empty cartridge in barrel is under pressure from the internal spring. Be alert when removing head of the barrel.

### Loading the grease gun

4. Remove any cartridge in the grease gun barrel (1) prior to refilling.
5. First pull out the plunger handle (6) to its maximum distance and lock it in place.
6. Remove the grease gun head (2) by turning it counter clockwise.
7. Remove any empty cartridge.

Always follow the steps listed above in preparing to load grease gun before proceeding to the appropriate loading method.

There are 4 ways to load this grease gun:

- **Cartridge loading**
- **Bulk fill**
- **Suction fill**
- **Filler pump loading**

### Cartridge loading

1. Fully draw back the plunger handle (6) and lock it in place.
2. Remove the grease gun head (2) from the grease gun barrel (1) by turning it counter clockwise.
3. Insert the open end of the cartridge into the grease gun barrel (1) and push it all the way in.
4. Remove the seal or pull tab end from the cartridge.
5. Reassemble the grease gun head (2) to the grease gun barrel (1) by turning it clockwise.

### Bulk fill

1. Fully draw back the plunger handle (6) and lock it in place.
2. Remove the grease gun head (2) from the grease gun barrel (1) by turning it counter clockwise.
3. Fill the grease gun barrel (1) with grease using a spatula.
4. Reassemble the grease gun head (2) to the grease gun barrel (1) by turning it clockwise

### Suction fill

1. Remove the grease gun head (2) from the grease gun barrel (1) by turning it counter clockwise.
2. Submerge the open end of the grease gun barrel (1) into grease bucket by approximately 2" and fully draw back the plunger handle (6) and lock it in place.
3. Reassemble the grease gun head (2) to the grease gun barrel (1) by turning it clockwise.

### Filler Pump loading

1. Fully draw back the plunger handle (6) and lock it in place.
2. Insert bulk loader valve (9) into the filler pump socket.
3. Operate the filler pump to fill the grease gun barrel (1).
4. Disconnect the grease gun from the filler pump.

### CAUTION!

- Do not apply excessive torque or over-tighten the grease gun head as this will apply undue stress to the die cast outlet and may cause it to fracture.

### Removing trapped air

After filling grease gun, trapped air should be removed by following the below steps.

### General procedure

1. While screwing back the grease gun head (2) onto the grease gun barrel (1), make sure to tighten it only half way, leaving 2-3 turns before the head is fully tight.
2. Release the plunger handle (6) and push down on it.
3. Force the plunger rod (7) in & out a few times in order to compress the grease & force out trapped air in the grease from the loose connection between the grease gun head (2) & grease gun barrel (1)
4. Start operating the grease gun lever (5) till grease starts flowing out continuously. At first discharge of grease, there may be some air bubble but will be followed by continuous flow of grease. If the grease is still accompanied with air bubble, repeat the above steps again.
5. Once all the air bubbles are removed and grease starts flowing out continuously, fully tighten the grease gun head (2) onto the grease gun barrel (1)
6. The grease gun is now ready to use.

### Procedure for grease gun with air release valve

1. After filling grease gun barrel (1) with grease by any of the above methods, reassemble the gun.
2. Tap the manual air release valve (8) to release the trapped air.
3. Move the plunger rod (7) forward and backward to remove any trapped air pockets.
4. Tap the manual air release valve (8) again to release the trapped air.
5. The grease gun is now ready to use.

### OPERATING INSTRUCTIONS

#### (Refer "EXPLODED VIEW")

1. The grease coupler (3) provided at the end of the extension (4) has a jaw type construction. The coupler jaws will snap on to a grease fitting and maintain a tight fit.

2. When connecting the grease coupler (3) to the grease fitting, press the grease coupler (3) straight onto the grease fitting to form a snug fit.
3. Start operating the lever (5) with the grease coupler (3) as aligned to the grease fitting as possible.
4. Once greasing is completed, slightly tilt the grease coupler (3), twist and pull back.
5. The tilt and twist action will allow easy removal of the grease coupler (3) from the grease fitting.

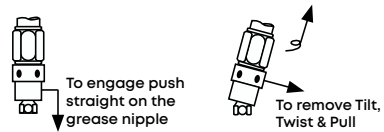

### WARNING!

- Do not exceed the maximum working pressure of 10,000 PSI.

### MAINTENANCE

#### (Refer "EXPLODED VIEW")

- Grease gun and extension (4) should be kept clean and checked for damage before each use.

**EXPLODED VIEW**

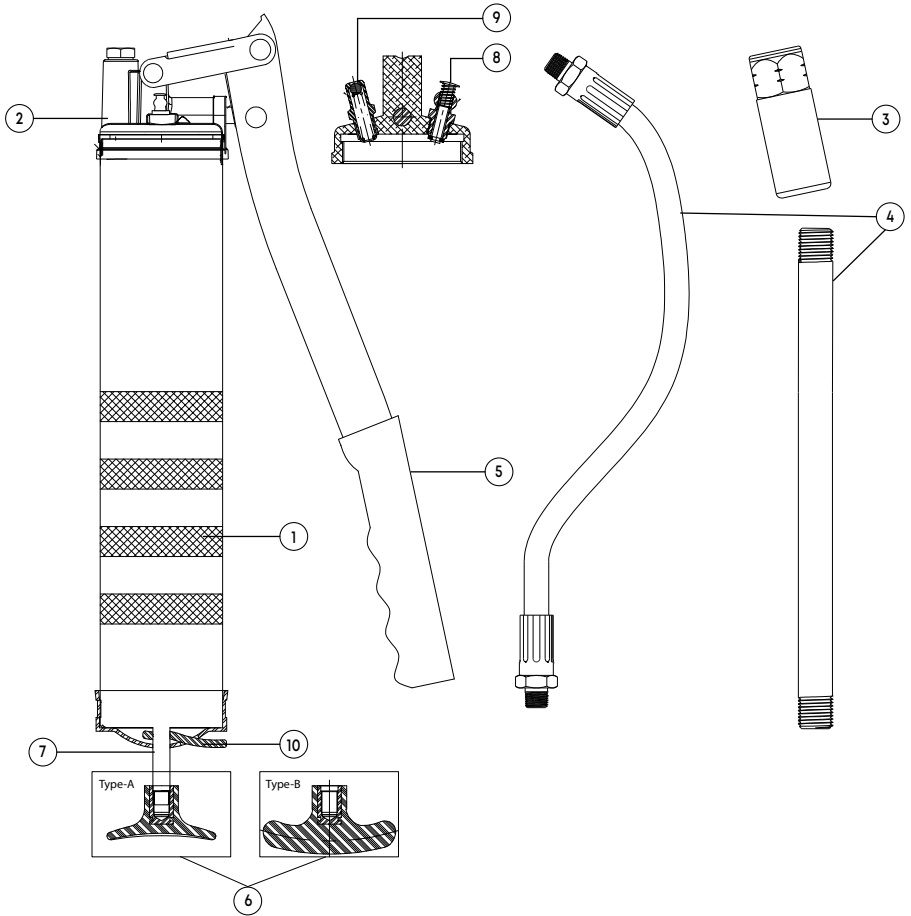

**PARTS LIST**

REF NO.	PARTS DESCRIPTION	QUANTITY
1	Grease gun barrel	1
2	Grease gun head	1
3	Grease coupler	1
4	Extension (Rigid steel/Flexible hose)	1
5	Lever	1
6	Plunger handle	1

REF NO.	PARTS DESCRIPTION	QUANTITY
6 (a)	Type-A*	
6 (b)	Type-B**	
7	Plunger rod	1
8	Air release valve	1
9	Bulk loader valve	1
10	Lock Lever	1

\*For G1 versions only

\*\*For G4, G10 & G18 versions

---

**TROUBLESHOOTING**

PROBLEM	POSSIBLE CAUSE	CORRECTIVE ACTION
Grease gun pumps little or no grease.	Barrel not completely tightened.	Tighten the barrel completely
	Air Pockets are trapped in grease	Remove air pocket by referring to "Removing trapped air" section
	Blocked grease gun extension	Remove the extension and operate the grease gun. If the gun dispenses grease then the gun is fine. Clean or replace the extension
	Grease too thick or cold	Store grease gun and grease away from extreme cold or use thinner grease
Excessive grease leaking past the follower	Follower is damaged	Replace the grease gun
If the gun still doesn't operate		Contact nearest authorized service dealer

**DISPOSAL**

The components or the used products must be given to companies that specialize in the disposal and recycling of industrial waste.

---

A series of horizontal dotted lines for writing.

**NOTE**



---

A series of horizontal dotted lines for writing.

**NOTE**