

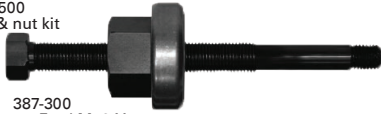

387-500
Bearing & nut kit



387-300
Center Screw Ford M12 X 1.5



387-250
Center Screw M12 X 1.75



387-200
Center Screw GM M16 X 2.0



387-400
Center Screw Mopar/GM M14 X 1.5



Kit includes:
M16x2.0 - GM
M14x1.5 - Dodge, Chrysler, Jeep
M12x1.75 - Dodge, Chrysler, Jeep
M12x1.5 - Ford

www.matcotools.com



387-500
Bearing & nut kit

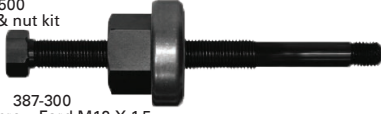

387-300
Center Screw Ford M12 X 1.5



387-250
Center Screw M12 X 1.75



387-200
Center Screw GM M16 X 2.0



387-400
Center Screw Mopar/GM M14 X 1.5



El kit incluye:
M16x2.0 - GM
M14x1.5 - Dodge, Chrysler, Jeep
M12x1.75 - Dodge, Chrysler, Jeep
M12x1.5 - Ford

www.matcotools.com



387-500
Bearing & nut kit

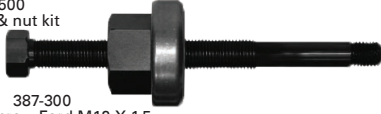

387-300
Center Screw Ford M12 X 1.5



387-250
Center Screw M12 X 1.75



387-200
Center Screw GM M16 X 2.0



387-400
Center Screw Mopar/GM M14 X 1.5

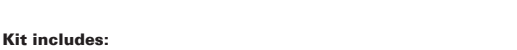

Kit includes:
M16x2.0 - GM
M14x1.5 - Dodge, Chrysler, Jeep
M12x1.75 - Dodge, Chrysler, Jeep
M12x1.5 - Ford

www.matcotools.com

LONG REACH HARMONIC BALANCER/PULLEY INSTALLER

LRHB700

XXXXXXXX-XX

SEE DIAGRAM FOR CORRECT USE

Install crank pulley or underdrive pulley on many late model Ford, GM, Dodge and Chrysler vehicles with V8 and V6 engines, with or without recessed threads. Traditional smaller installer kits will not work in many of these applications.

1. Pick appropriate shaft for application.
2. Coat crankshaft snout and damper inside diameter with anti-seize compound to prevent galling during removal / installation.
3. Thread Nut / Bearing Assembly on shaft making sure bearing is facing crankshaft.
4. Thread shaft and tighten to crankshaft snout.
5. Using an open box wrench and a ratcheting drive, turn nut clockwise until damper is fully seated against timing gear or spacer.

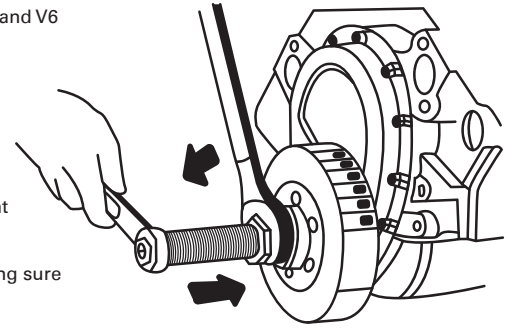

Made in Taiwan

INSTALADOR DE POLEAS PARA AMORTIGUAR LA VIBRACIÓN DE LARGO ALCANCE

LRHB700

XXXXXXXX-XX

EL DIAGRAMA PARA EL USO CORRECTO

Puede instalar la polea del cigüeñal o la polea ligera (underdrive) en muchos de los últimos modelos Ford, GM, Dodge y Chrysler con motores V8 y V6, con o sin roscas empotradas.

1. Seleccione el eje apropiado para la aplicación.
2. Recubra la punta del cigüeñal y el diámetro interior del amortiguador del cigüeñal con un compuesto que evite que se peguen, para evitar problemas durante la instalación.
3. Coloque la tuerca/cojinete en el eje, asegurándose de que el cojinete quede orientado hacia el cigüeñal.
4. Enrosque el eje y ajuste a la punta del cigüeñal.
5. Con una llave de tuercas y un trinquete, haga girar la tuerca en el sentido de las agujas del reloj hasta que el amortiguador se encuentre totalmente apoyado contra el engranaje de tiempos o el espaciador.

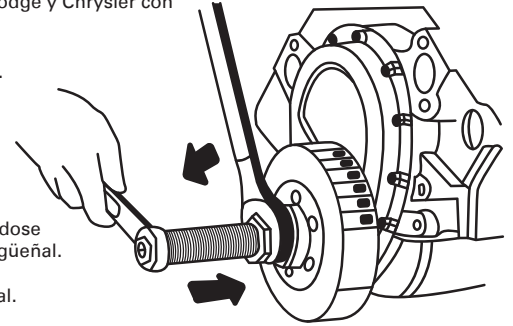

Fabricado en Taiwan

LONG REACH HARMONIC BALANCER/PULLEY INSTALLER

LRHB700

XXXXXXXX-XX

SEE DIAGRAM FOR CORRECT USE

Install crank pulley or underdrive pulley on many late model Ford, GM, Dodge and Chrysler vehicles with V8 and V6 engines, with or without recessed threads. Traditional smaller installer kits will not work in many of these applications.

1. Pick appropriate shaft for application.
2. Coat crankshaft snout and damper inside diameter with anti-seize compound to prevent galling during removal / installation.
3. Thread Nut / Bearing Assembly on shaft making sure bearing is facing crankshaft.
4. Thread shaft and tighten to crankshaft snout.
5. Using an open box wrench and a ratcheting drive, turn nut clockwise until damper is fully seated against timing gear or spacer.

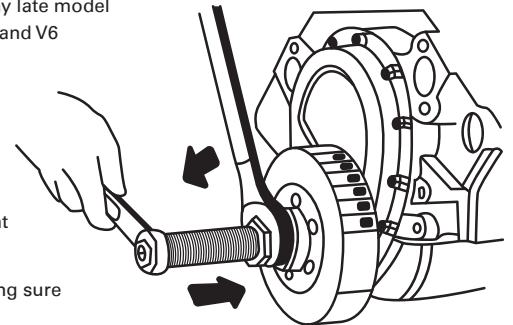

Fabriqu e   Taiwan