

MG200S - SYNERGIC 3-IN-1 WELDER

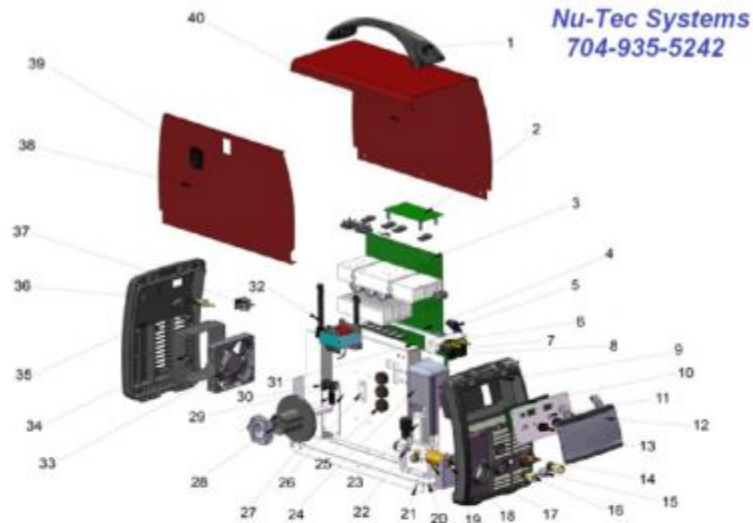

MULTIMIG 200S Synergic PFC

#	Part #	Description	#	Part #	Description
1	521.0101	Handle	21	521.0121	Hinge and bracket
2	521.0102	Control board	22	521.0122	Connecting rod
3	521.0103	Main board	23	520.3019	Wire feed drive (148/200/208)
4	521.0104	Insulation paper	24	521.0124	Protective cover
5	521.0105	"Y" Hose Fitting	25	521.0125	Transfer connector
6	521.0106	Installation plate for valve	26	521.0126	Connecting copper bar
7	521.0107	Solenoid Valves	27	521.0127	Medium panel
8	521.0108	Side plate	28	521.0128	Spool holder
9	521.0109	Front frame	29	521.0129	Gas / Feed switch
10	521.0210	Front panel LCD	30	521.013	Spool or Remote switch
11	521.0111	Installation plate of panel	31	521.0131	MULTIMIG200 power board
12	521.0112	Front panel cover plate	32	521.0132	160 Support rod
13	521.0113	Knob	33	521.0133	Cooling Fan
14	521.0114	Gas-out connector	34	521.0134	1225 fan cover
15	521.0115	Female torch connector	35	521.0135	Rear Frame
16	521.0116	Female torch connector	36	521.0136	Gas-in connector
17	521.0117	Central Socket locker	37	521.0137	Power switch(red)
18	521.0118	Central Socket	38	521.0138	Right side frame
19	521.0119	Gas-in connector	39	521.0139	Square box handle
20	521.012	Bottom board	40	521.014	Left side plate

Item: MG200S

Description: SYNERGIC 3-IN-1 WELDER

Notes: MGS200S has an M warranty to prevent the entire unit from being sent for repair without first contacting the Supplier to Troubleshoot the issue with the Welder. During the Troubleshooting process it may be determined that replacement parts could be sent to the Customer rather than returning the welder for repair. If troubleshooting is unsuccessful, the supplier will advise that the machine will need to be sent to the factory.

Figure No	Part Number	Description	No. Reqd	Warranty Code
-----------	-------------	-------------	----------	---------------