

SE140A - AIR BELT SANDER (1/2" X 18")

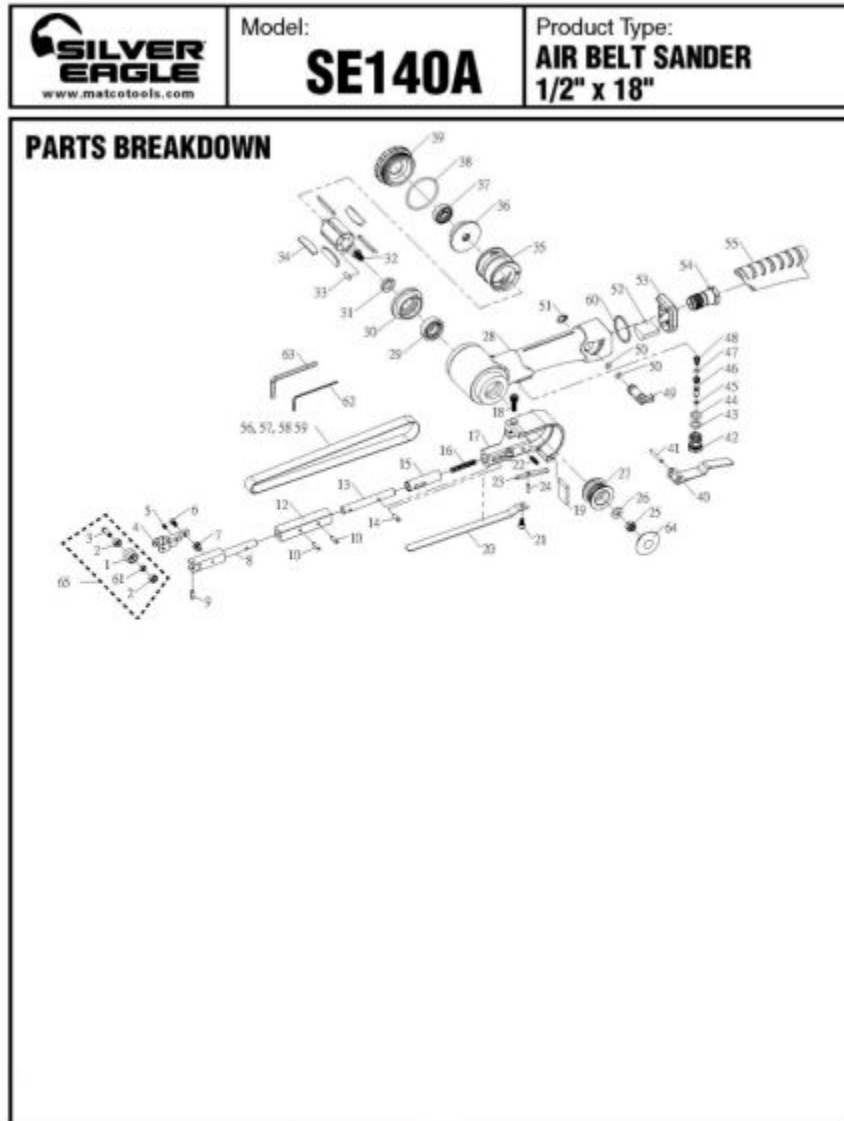

Item: SE140A

Description: AIR BELT SANDER (1/2" X 18")

Notes: H13037PAR is the current SE140A front roller bearing (rubber/nylon coated) H13037PAS is the optional all steel roller for the SE140A (more durable, but also faster belt wear)

Figure No	Part Number	Description	No. Reqd	Warranty Code
0	H13037UPD	IDLE PULLEY ASSEMBLY WITH NO4	1	T
1	H13037PAR	IDLE PULLEY ASSEMBLY	1	L
1	H13037PAS	IDLE PULLEY ASSEMBLY	1	L
2	H13037-02	BEARING FOR SE140A (2 REQ D)	2	L
3	*H13037-03	IDLE PULLEY SCREW	1	
4	H13037UPD	IDLE PULLEY ASSEMBLY WITH NO4	1	T
5	H13037-05	SET SCREW FOR SE140	1	D
6	H13037-06	PHILLIPS SCREW FOR SE140	1	D
7	H13037-07	SPRING FOR SE140	1	D
8	H13037-08	TENSION BAR FOR SE140	1	D
9	H13037-09	SPRING PIN FOR SE140	1	D
10	H13037-10	STOPPER PIN FOR SE140	2	D
12	H13037-12	TENSION SPINDLE F/SE140	1	D
13	H13037-13	DEAD HANDLE F/SE140	1	D
14	H13037-14	STOPPER PIN #14	1	L
15	H13037-15	GUARD BUSHING F/SE140A	1	L
16	H13037-16	TENSION SPRING F/ SE140A	1	L
17	H13037-17	GUARD SUB ASSEMBLY F/SE140	1	L
18	*H13037-18	HEAD CAP SCREW (M5X15)	1	
19	H13036-15	DUST COVER F/SE130	1	D
20	H13037-20	SHOE 12 F/SE140	1	D
21	*H13037-21	HEXAGON SOCKET HEADLESS SET SCREW	1	
22	H13037-22	STOPPER SPRING F/ SE140A	1	L
23	*H13037-23	STOPPER	1	
24	*H13037-24	SPRING PIN (02.5X10)	1	
25	*H13037-25	HEXAGON NUT (M6)	1	
26	*H13037-26	WASHER (M6)	1	
27	H13036-23	DRIVE PULLEY SE130	1	X
28	*H13037-28	HOUSING	1	
29	*H13037-29	BALL BEARING	1	
30	H13037-30	FRONT END PLATE F/ SE140A	1	L
31	H13036-27	SPACER F/ SE140A	1	X

32	*H13037-32	ROTOR	1	
33	H13037-33	PARALLEL KEY BOTH ENDS ROUND	1	L
34	H13037-34	ROTOR BLADE	5	L
35	*H13037-35	CYLINDER	1	
36	*H13037-36	REAR END PLATE	1	
37	*H13037-37	BALL BEARING (608ZZ)	1	
38	*H13037-38	O-RING (S38)	1	
39	*H1SE140A-39	CAP	1	
40	H13037-40	THROTTLE LEVER F/SE140	1	L
41	*H13037-41	SPRING PIN (03X20)	1	
42	*H13037-42	VALVE BODY	1	
43	*H13037-43	O-RING (S11.2)	1	
44	H13037-44	O-RING (ID 9.8 X 2.4) F/ SE140	1	X
45	H13037-45	O-RING FOR SE140	1	L
46	*H13037-46	VALVE STEM	1	
47	*H13037-47	O-RING (P3)	1	
48	H13036-43	VALVE SPRING F/SE130	1	L
49	H13036-44	AIR REGULATOR FOR SE130	1	L
50	H13037-50	O RING FOR SE140A	2	L
51	H13037-51	CLIP	1	L
52	H13037-52	MUFFLER F/ SE140	1	D
53	*H13037-53	EXHAUST DIFFUSER	1	
54	*H13037-54	INLET BUSHING	1	
55	*H1SE140A-55	HOUSING COVER	1	
57	SE140-40A	40 GRIT GRINDING BELT - 10PC	1	T
58	SE140-60A	60 GRIT GRINDING BELT - 10PC	1	T
59	SE140-80A	80 GRIT GRINDING BELT - 10PC	1	T
60	H13037-60	RING	1	L
61	*H13037-61	WASHER	1	
62	*H13037-62	HEX. WRENCH	1	
63	*H13037-63	HEX. WRENCH	1	
64	H13037-64	PULLEY COVER FOR SE140A	1	L
65	H13037PAR	IDLE PULLEY ASSEMBLY	1	L
66	SE140-100A	100 GRIT GRINDING BELT - 10 PC	1	T