



# OWNER'S MANUAL

## Model No. SHPSADJ

### Save This Manual For Future Reference

## ADJUSTABLE HEIGHT SHOP STOOL

### DESCRIPTION

Adjustable Height Shop Stool is ideal for workbench height applications. Seat height is adjustable from 29"–34". Seat is 14" diameter and 3½" thick and back is 12" x 6" x 2½" thick. Back has manual back depth adjustment. Frame is 1" chrome finished tubular steel with 18" diameter steel foot ring. Legs have adjustable foot glides.

### ASSEMBLY INSTRUCTIONS

**Read these instructions before starting; follow assembly procedures carefully.**

1. Thread glides (Key No. 1) into each of the legs (Key No. 2). Glides will need to be adjusted after stool is fully assembled.
2. Attach foot ring (Key No. 3) to legs using 1/4"-20 1¼" pan head screw (Key No. 4). Do NOT tighten screws completely.
3. Align hole in top of leg with hole in hub bracket (Key No. 9). Slide carriage bolt (Key No. 10) through hole in hub bracket and through hole in leg. Align one of the holes in flange of cylinder support tube (Key No. 5) with carriage bolt and slide cylinder support tube upward. Slide flat washer and lock washer ( Key Nos. 7 and 8) onto threading of carriage bolt. Thread fiber hex nut (Key No. 6) onto carriage bolt and finger tighten hex nut. Repeat process for three other carriage bolts. Securely tighten all hex nuts on carriage bolts and all screws for foot ring.
4. Insert the lift assembly (Key No. 11) into cylinder support tube with tapered end down. Secure lift assembly by applying a little downward pressure. Remove black plastic cap from top of lift assembly. Do **NOT** push on button at the top!
5. Place hub cover (Key No. 12) over lift assembly. Align cutouts in sides of hub cover with legs and push cover down over tops of legs.
6. Install seat with control assembly (Key Nos. 14 and 16) by aligning hole in the control with the shaft of lift assembly. Push down firmly on seat. Handle on control can be pulled up to raise and lower seat.
7. Attach back bars to back (Key Nos. 19 and 21) using pan head screws (Key No. 20), but do not tighten screws completely.
8. Insert back bars into lift and right back bar support brackets (Key Nos. 15 and 18) and slide bars into brackets several inches. Secure back bars with knobs (Key No. 17). Securely tighten all four screws to back.
9. Place shop stool on floor and adjust glides if needed.

### GENERAL SAFETY INSTRUCTIONS

- Do not stand on seat.
- Stool must be on level surface to ensure proper stability.
- Only use stool when fully assembled.
- Periodically check fasteners and tighten securely if needed.
- Never use stool if it does not perform according to this manual.
- Do not exceed stool maximum weight capacity of 300 pounds.

### MAINTENANCE

Pneumatic lift in lift assembly is permanently lubricated at factory and needs no further lubrication. **Never lubricate pneumatic lift.** Do not remove clip from bottom of lift assembly. Contact Matco Tools immediately if clip is missing or damaged.

### INDUSTRIAL SEATING LIMITED WARRANTY

Product is warranted against mechanical or structural failure due to defective material or workmanship for 1 year. Provided however, this warranty lasts only so long as you own your product. If you sell or otherwise transfer the product this warranty terminates automatically. Products that are damaged or made unserviceable by accidents, abuse, misuse or are altered in anyway are not covered by this warranty.

Matco Tools reserves the right to replace or recondition at its option, any units covered by this warranty. All return shipments require Material Return Authorization and must be freight prepaid unless otherwise approved in writing.

If any product covered under this warranty fails to meet the terms of this warranty or it is in any respect broken, defective or missing parts, please call us immediately at toll free 1-866-289-8665. Any attempts to make unauthorized repairs will void this warranty in every respect.

This warranty gives you specific legal rights. You may have other rights which vary from state to state, however such implied rights are limited to a period of one year from the date of your initial purchase. Some states do not allow limitations on how long an implied warranty lasts, so the above limitation may not apply to you.

Matco Tools will in no event be liable for incidental or consequential damages for any amount in excess of the original purchase price. Some states do not allow exclusion or limitation of such damages, so the above limitation or exclusion may not apply to you.

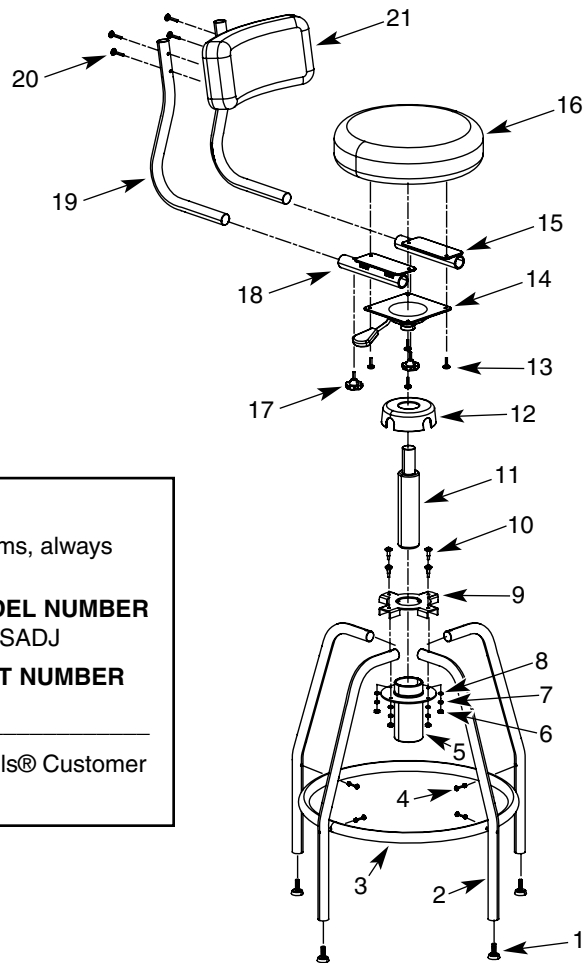

### HOW TO ORDER REPAIR PARTS

When ordering repair parts or reporting problems, always give the following information:

<b>NAME OF ITEM</b>	<b>MODEL NUMBER</b>
Adjustable Height Shop Stool	SHPSADJ
<b>PART DESCRIPTION</b>	<b>PART NUMBER</b>
_____	_____

All parts listed may be ordered from Matco Tools® Customer Service at 1-866-289-8665.

### PARTS LIST

KEY NO.	DESCRIPTION	QTY	PART NO.
1	Glide	4	10303.00
2	Leg	4	10304.00
3	Foot Ring	1	10305.00
4	1/4-20 x 1 1/4" Phillips Serrated Washer Pan Head Screw	4	10306.00
5	Cylinder Support Tube	1	10307.00
6	5/16"-18 Fiber Hex Nut	4	09043.00
7	5/16" Lock Washer	4	07841.00
8	5/16" Flat Washer	4	03494.00
9	Hub Bracket	1	10308.00
10	5/16-18 x 1 3/4" Carriage Bolt	4	10309.00
11	Lift Assembly	1	10310.00
12	Hub Cover	1	10311.00
13	1/4-20 x 1" Hex Head Bolt with Washers	4	06552.00
14	Control Assembly	1	10312.00
15	Left Back Bar Support Bracket	1	10313.00
16	Seat	1	10322.04
17	Knob	2	10315.00
18	Right Back Bar Support Bracket	1	10316.00
19	Back Bar	2	10317.00
20	1/4-20 x 2" Phillips Serrated Washer Pan Head Screw	4	10318.00
21	Back	1	10319.00