



OWNER'S MANUAL

Model No. SRVSADJ

Save This Manual For Future Reference

ADJUSTABLE HEIGHT SERVICE STOOL

DESCRIPTION

Adjustable Height Service Stool seat height is adjustable from 29" to 33". Seat is 14" wide and 13" deep. Seat provides comfort, strength and easy maintenance. Seat has forward seat tilt. Reinforced round steel base. Stool has 300 pound weight capacity.

ASSEMBLY

1. Unpack your stool and account for all parts.
2. Place base (Key No. 1) onto floor and insert foot ring (Key No. 2) into center of base. Push down on foot ring and allow it to wedge firmly into place.
3. Insert lift assembly (Key No. 3) into top hole of foot ring and press firmly into place. Remove cap from top of lift assembly. Do **NOT** push on button at the top!
3. Install seat on top of lift. Align hole in control assembly (Key No. 5) with top of lift. Push down on seat (Key No. 6) to insert firmly together.

ADJUSTING SEAT ANGLE AND HEIGHT

1. Raise handle under right side of seat and tilt seat to desired angle. Lower handle to lock seat at desired angle.
2. Raise handle under left side of seat to move seat to desired height. Lower handle to lock seat at desired height.

GENERAL SAFETY INSTRUCTIONS

- Do not stand on seat.
- Stool must be on level surface to ensure proper stability.
- Only use stool when fully assembled.
- Periodically check fasteners and tighten securely if needed.
- Never use stool if it does not perform according to this manual.
- Do not exceed stool maximum weight capacity of 300 pounds.

MAINTENANCE

Pneumatic lift in lift assembly is permanently lubricated at factory and needs no further lubrication. **Never lubricate pneumatic lift.** Do not remove clip from bottom of lift assembly. Contact Matco Tools immediately if clip is missing or damaged.

INDUSTRIAL SEATING LIMITED WARRANTY

Product is warranted against mechanical or structural failure due to defective material or workmanship for 1 year. Provided however, this warranty lasts only so long as you own your product. If you sell or otherwise transfer the product this warranty terminates automatically. Products that are damaged or made unserviceable by accidents, abuse, misuse or are altered in anyway are not covered by this warranty.

Matco Tools reserves the right to replace or recondition at its option, any units covered by this warranty. All return shipments require Material Return Authorization and must be freight prepaid unless otherwise approved in writing.

If any product covered under this warranty fails to meet the terms of this warranty or it is in any respect broken, defective or missing parts, please call us immediately at toll free 1-866-289-8665. Any attempts to make unauthorized repairs will void this warranty in every respect.

This warranty gives you specific legal rights. You may have other rights which vary from state to state, however such implied rights are limited to a period of one year from the date of your initial purchase. Some states do not allow limitations on how long an implied warranty lasts, so the above limitation may not apply to you.

Matco Tools will in no event be liable for incidental or consequential damages for any amount in excess of the original purchase price. Some states do not allow exclusion or limitation of such damages, so the above limitation or exclusion may not apply to you.

HOW TO ORDER REPAIR PARTS

When ordering repair parts or reporting problems, always give the following information:

NAME OF ITEM	MODEL NUMBER
Adjustable Height Service Stool	SRVSADJ
PART DESCRIPTION	PART NUMBER
_____	_____

All parts listed may be ordered from Matco Tools® Customer Service at 1-866-289-8665.

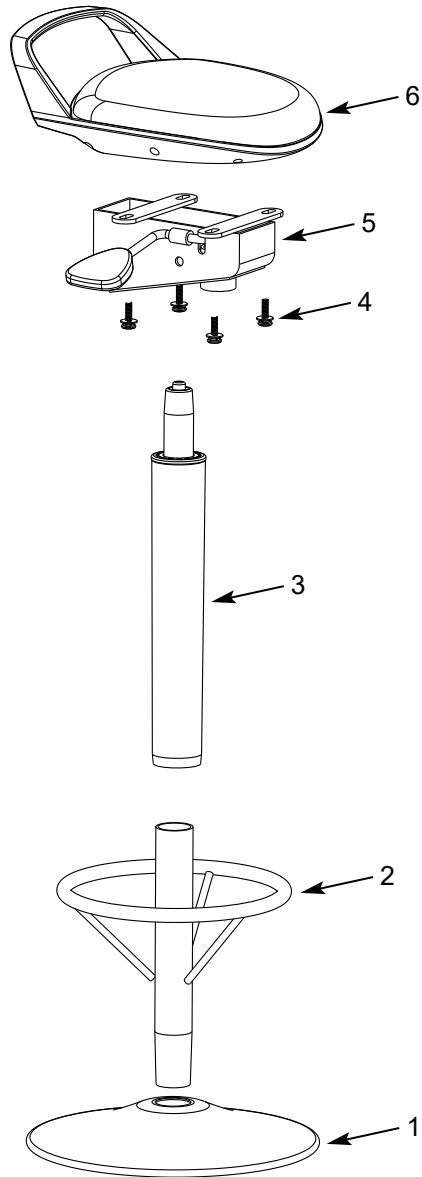

PARTS LIST

KEY NO.	DESCRIPTION	QTY.	PART NO.
1	Round Base	1	10290.00
2	Foot Ring	1	11021.00
3	Lift Assembly	1	11020.00
4	1/4" - 20 x 7/8" Phillips Pan Head Screws with Washers	4	10640.01
5	Control Assembly	1	10289.01
6	Seat	1	10775.04