

RATCHET REPAIR KIT

JUEGO DE REPARACIÓN DEL MANERAL

MANERAL DE 72 DIENTES CON ACOPLE DE 1/2"

Disassembly:

1. Hold handle securely in a vise with the square drive up. Clean COVER PLATE and RETAINING RING with a dry towel.

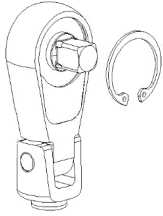

2. Using a pair of snap ring pliers, remove retaining ring from handle

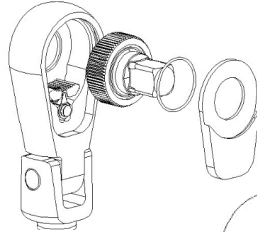

3. Pull on square end of GEAR to remove GEAR, O-RING and COVER PLATE from handle.

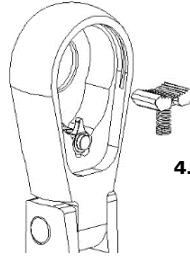

4. Remove PAWL and SPRING.

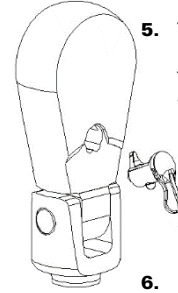

5. Tilt and remove the REVERSING LEVER from the top side of the handle as shown.

6. Remove debris and spray the inside of the handle with WD-40™ or an equivalent thin film penetrating lubricant to clean.

Assembly:

Use all new parts in kit. For best results, hold handle in vise with the head up.

1. Install O-RING into groove at the base of the square GEAR.

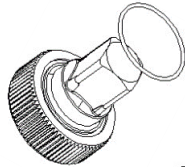

2. Insert REVERSING LEVER SPRING into REVERSING LEVER.

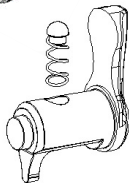

3. Install REVERSING LEVER, tilting it forward as it goes into the opening. Depress the REVERSING LEVER SPRING as you insert into the handle.

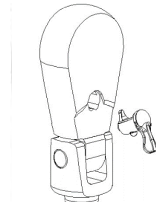

4. Insert the PAWL and SPRING into the handle opening. PAWL slot must face outward. SPRING must nest into the circular recess of the REVERSING LEVER as shown.

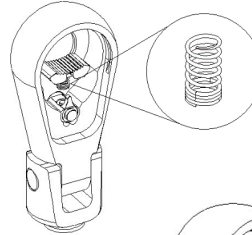

Note: make sure pawl spring is orientated as shown

7. Insert GEAR

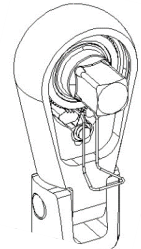

8. Insert the COVER PLATE into the HANDLE and pull out slightly. Using snap ring pliers, install the RETAINING RING into the retaining ring groove of the GEAR. While keeping RETAINING RING compressed, push GEAR, COVER PLATE and RETAINING RING into the HANDLE.

3. Install REVERSING LEVER, tilting it forward as it goes into the opening. Depress the REVERSING LEVER SPRING as you insert into the handle.

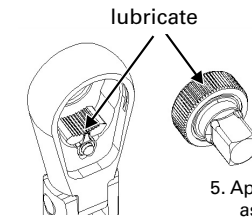
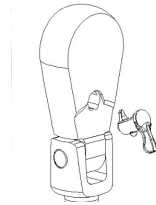

lubricate

5. Apply grease as shown.

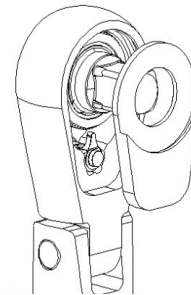

6. Depress PAWL with the included ASSEMBLING TOOL.

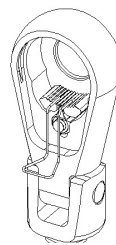

9. Check functionality by rotating the GEAR and REVERSING LEVER in both directions. Ratcheting action should be smooth and consistent in both directions.

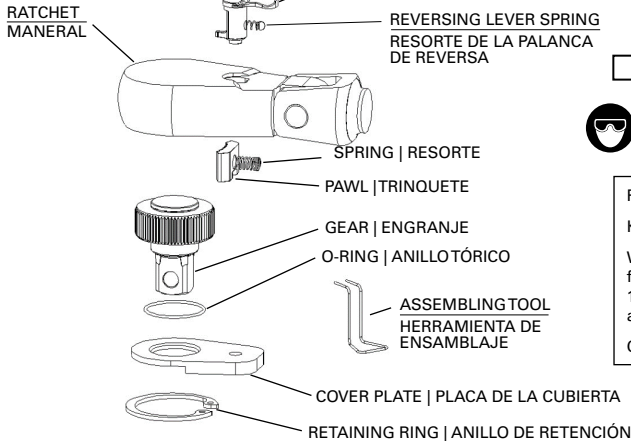
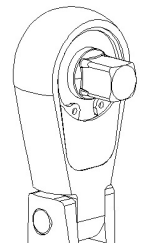

⚠ WARNING

⚠ ADVERTENCIA

⚠ AVERTISSEMENT



CAUTION: Wear Eye Protection While Repairing Ratchet.

PRECAUCIÓN: Use protección para los ojos mientras repara el maneral.

ATTENTION : Protégez vous les yeux lors de la réparation d'un cliquet.

Ratchet Lubricant

Keep out of reach of children.

WARNING: In case of eye contact, flush immediately with water for 15 minutes. Wash hands with soap and water after using.

Contains petroleum lubricating oil.

Lubricante para el maneral

Manténgalo fuera del alcance de los niños.

ADVERTENCIA: En caso de contacto con los ojos, enjuáguelos inmediatamente con agua durante 15 minutos. Lávese las manos con jabón y agua después de usarlo.

Contiene aceite lubricante con base de petróleo.

Lubrifiant à cliquet

À garder hors de portée des enfants.

AVERTISSEMENT : Si le produit entre en contact avec vos yeux, rincez les immédiatement à l'eau pendant 15 minutes. Lavez vous les mains avec de l'eau et du savon avant l'utilisation.

Contient de l'huile de graissage à base de pétrole.